

Rev	Date	Drawn	Description
-	30.08.18	RUH	Issue in advance of DRP
A	12.11.18	EVM	Issue to consultant team
B	31.01.19	EVM	Issue for Planning
C	01.02.19	PPR	Revised Issue for Planning

Key

— Proposed Planning Application Boundary

Notes
Do not scale from drawings unless by agreement with HTA. Use figured dimensions only. Check all dimensions on site prior to commencing the works. Drawing to be read in conjunction with other relevant consultant information.

This drawing is the copyright of HTA Design LLP and must not be copied or reproduced in part, or in whole, without the express permission of HTA Design LLP.
Drawing to be read in conjunction with outline specification.

Site Location Plan
drawing title Tower House and Ashbourne House, Slough

Slough Borough Council
client / project

PLANNING
status

HTA-A_DR_0001
drawing number

1:1,250
scale @ A3



C
revision

SBC-TAH
project number

HTA Design LLP
78 Chamber Street
London, E1 8BL
020 7485 8555
www.hta.co.uk

RUH
originated by



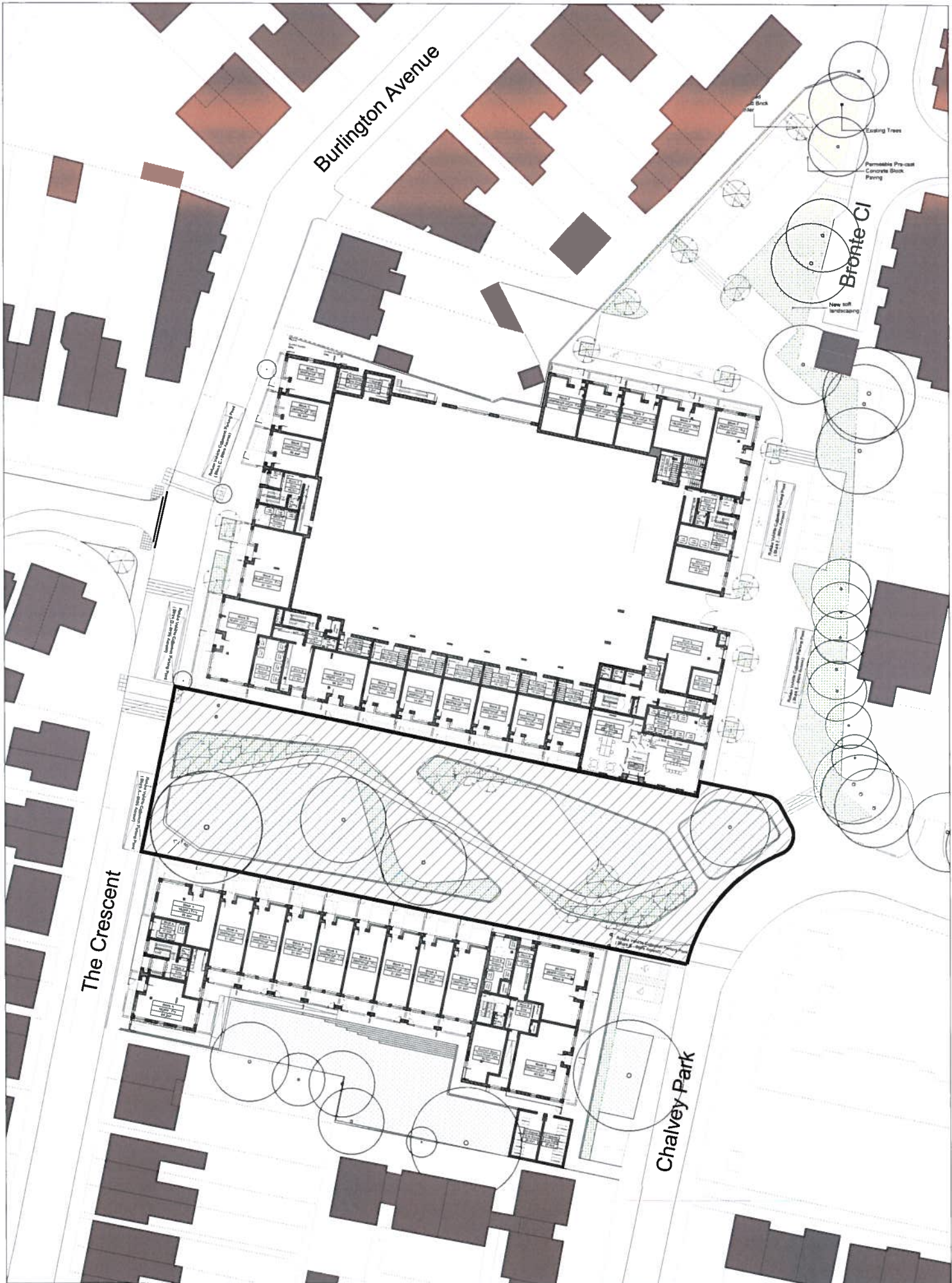

Rev. Date Description

Do not replicate drawings without the agreement with HTA. Use Squared dimensions only. Check all dimensions on site prior to commencing the works. Drawing to be read in association with other relevant contract information. This drawing is the copyright of HTA Group LLP and must not be copied or reproduced in part, or in whole, without the express permission of HTA Group LLP. Drawing to be read in association with tender specification.

Key
 Public open space 2307m2

Mark up of public open space

Slough Borough Council
 Issue 2/2020

SBC-TAH_HTA_L_09-XL-SK_5000
 drawing number
250
 issue 2/20

SBC-TAH
 project number
 CDA
 contractor

FOR INFORMATION

HTA Design LLP
 78 Chamber Street
 London, E1 6SE
 020 7488 8555
 www.hta.co.uk

HTA Design LLP
 88 Midland Road
 Epsom, Surrey, E15 8AE
 0131 344 4742
 www.hta.co.uk

